

APPENDIX C

~~Joy~~ & Peter McNally
Garden House, The Avenue, Exton, Rutland LE15 8AH
Tel. 01572 811183
mcnallyuk@aol.com

To Mr. S. Crook



28/08/2020

Dear Stuart,

Re. Countryside Stewardship - applied
for by Exton Park Farms. And they
are leasing some of this agricultural land
to EON ENERGY Ltd for a SOLAR FARM.??
Regards, Peter McNally

Countryside Stewardship Agreement Document



The European Agricultural Fund
for Rural Development:
Europe investing in rural areas



Forestry Commission



Agreement Name: Exton Park Farms

Agreement Document Type: Higher Tier

Agreement Number: 651459

Agreement Start Date: 01/01/2019

Agreement End Date: 31/12/2028

SBI: [REDACTED]
Agreement Holder: **EXTON PARK FARMS**
Address: **Exton Estate, Oakham, LE15 8AN**
Post code: **LE15 8AN**

Garden House, The Avenue
Exton, Oakham
Rutland
LE15 8AH

Highways Asset Management and Policy Officer
Rutland County Council,
Catmose, OAKHAM

27th August 2022

Dear Sirs,

HISTORIC FOOTPATH: EXTON TO BURLEY

It has been brought to my attention that there was a public footpath by the side of North Barn, The Avenue, Exton which has fallen into disuse and yet it has historical significance. At one end, The Grange, it meets the Avenue, formerly the Queen of Bohemia's Ride, which approaches the impressive crested gates to the Earl of Gainsborough's Estate, and to the Oakham Road, formerly Whitwell Road, leading to St Peter's and St Paul's Anglican church and to the pretty village of Exton.

The old path runs through woodland and then along a farm track bordered by hedgerow alongside wheat fields to "The Cocked Hat Spinney", used at one time, I believe, for rearing wild boar and for rearing pheasant.

The path then proceeds over fields crossing a stream and through more fields to meet Exton Lane. If you then walk past the Water Tower you will meet the footpath on the main road which leads past Home Farm, the listed farm which provided the produce for Burley-on-the-Hill and then to Oakham.

Whilst it would be of historical value to resurrect this path for ramblers it will also bring benefits to our local homes and lodges who have **no safe** access to pathways and **no** footpaths between Burley and Exton or places to walk, **nor** opportunity to exercise and enjoy our beautiful landscape. And yet there were close cultural and commercial ties between these two settlements in the past.

It is for this reason that I, and many others in our neighbourhood, would like to re-instate this footpath which was probably once upon a time a well used path for workers in the villages and for travellers to see their families or for citizens to find their way to church. Hence this Application. At this stage I enclose some preliminary evidence to show the path and its trajectory and also some photographs of its current state at each end.

Whether of historical significance or evidence or not, I should point out that there is a red Royal Mail pillar box at either end of the ancient path. And perhaps it is relevant that the houses at the Burley end of the path are named "Toll Bar House" and Ivy Cottage "Burley Toll Bar" suggesting there may have been a meeting of carriageways and pathways at this site.

I hope that you may support me through this journey and help me investigate evidence and make an assessment.

I provide here a list of evidence and historical mapping and recent photos of beginning and end to footpath. I am submitting the above **narrative** by way of reasoning and registering the Application Form A.

I am submitting here:-

- **Narrative** and reasoning as above.
- **Witness statement** by one of the three landowners
- **Witness statement** from a senior Exton resident living in a house on the Green
- **One Ordnance Survey** map clearly showing the route
- **An old OS map** - source to be verified
- **Land Registry map** showing how the land is divided in to parcels and referenced
- A **Scottish OS Map** published 1931
- A **further Scottish OS map**
- An **1897 map** from the **Finance Act** and the apportionments
- Two '**old definitive maps**' from RCC files
- **Seven photos** of current entrance and exit photos of the footpath path

I will now send Form B to each of the three landowners whose land the path crosses. I will then send you a Form C confirming that I have informed the Landowners that I have made this Application.

I will continue to do research in support of this Application

Yours faithfully,

Peter McNally

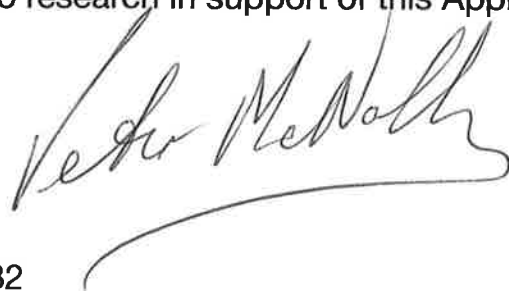
A handwritten signature in black ink, appearing to read 'Peter McNally', with a long horizontal flourish underneath.

tel. 01572 811183

mob. 07960 418382

email. McNallyUK@aol.com

Rutland County Council

APPLICATION FOR MODIFICATION ORDER

WILDLIFE & COUNTRYSIDE ACT 1981
DEFINITIVE MAP MODIFICATION ORDERS

(This form to be completed by the applicant and served on Rutland County Council)

To: **Public Rights of Way Officer, Rutland County Council, Catmose, Oakham LE15 6HP**

APPLICATION

I/We PETER McNALLY
of GARDEN HOUSE, THE AVENUE, EXTON, RUTLAND Post Code LE15 8AH
hereby apply for an order under Section 53 of the Wildlife & Countryside Act, 1981, to
modify the Definitive Map & Statement for the area by:-

(Delete any of the following sections that do not apply)

Deleting the footpath/bridleway/byway (delete as appropriate)

From To

OR

Adding the footpath/bridleway/byway (delete as appropriate)

From THE GRANGE, THE AVENUE, EXTON To EXTON LANE, BURLEY

OR

~~**Upgrading/Downgrading the footpath/bridleway/byway to a
footpath/bridleway/byway/restricted byway (delete as appropriate)**~~

From ~~THE GRANGE, THE AVENUE, EXTON~~ To ~~EXTON LANE, BURLEY~~

OR

Varying the particulars of the footpath/bridleway/byway (delete as appropriate)

From ~~THE GRANGE, THE AVENUE, EXTON~~ To ~~EXTON LANE, BURLEY~~
by providing that

(in all cases) and shown on the map annexed hereto.

I/We attach copies of the documentary evidence (including statements of witnesses) in
support of this application.

Signed



Dated

24 August 2022

From: McNally mcnallyuk@aol.com
Subject: Fwd: Footpath
Date: 25 Aug 2022 at 15:28:01
To: Peter McNally mcnallyuk@aol.com

Date: 25 August 2022 at 10:05:47 BST
To: McNally <mcnallyuk@aol.com>
Subject: Fwd: Footpath

From: Fay & Dan Howison <fayanddan1@waitrose.com>
Date: 24 August 2022 at 21:32:16 BST
Subject: Footpath

Hi Peter

I was interested that you had been looking at the possibility of reopening that footpath. The only drawback is that as you will have seen from the map it doubles back on itself when it reaches the track leading to Cow Close Farm, leaving rather a long stretch of road (Exton Lane) to negotiate. The ideal would be to negotiate a "permissive" path from that point on, but I have no idea whether that would be possible. I don't even know who owns that bit of land (Burley Estates ?). It would certainly offer an alternative to the rather dreary - and dangerous - slog up the Avenue, which, beautiful as it is, is not very walker-friendly. When I was putting together a plan to rationalise and reinstate the footpaths in Exton park I found it very useful to discuss my proposals with the Ramblers and the Leics. Footpath Association (in a pub!); but I expect you have thought of this.

Anyway, good luck wih your project.

Best wishes,

Dan.

From: **McNally** mcnallyuk@aol.com
Subject: **Fwd: Exton Solar farm: Evidence of a public right of way -
Witness statement**
Date: **24 Aug 2022 at 13:36:35**
To: **Peter McNally** mcnallyuk@aol.com

Begin forwarded message:

From: David Holland <davidnholland@hotmail.com>
Date: 7 August 2022 at 14:28:59 BST
To: McNally <mcnallyuk@aol.com>
Subject: Exton Solar farm: Evidence of a public right of way - Witness statement

Hi Peter,

"Witness statement"

It's come to my attention that a public right of way footpath that once started at the junction to Exton village and ran across the beautiful rolling Rutland countryside to Burley on the hill has been removed (evidence can be found in my previous email of the path being shown in various maps).

I am not sure why the land owners at the time (now Campden's and Hanbury's) did not maintain the path, but due to it not being maintained people did not use it and subsequently the path was removed from recent ordinance survey maps.

I would like the path reinstated one because it links Exton to Burley, I can use it to walk along with my family and also because there are no public footpaths in the immediate section of countryside in question.

Thanks



OS req?

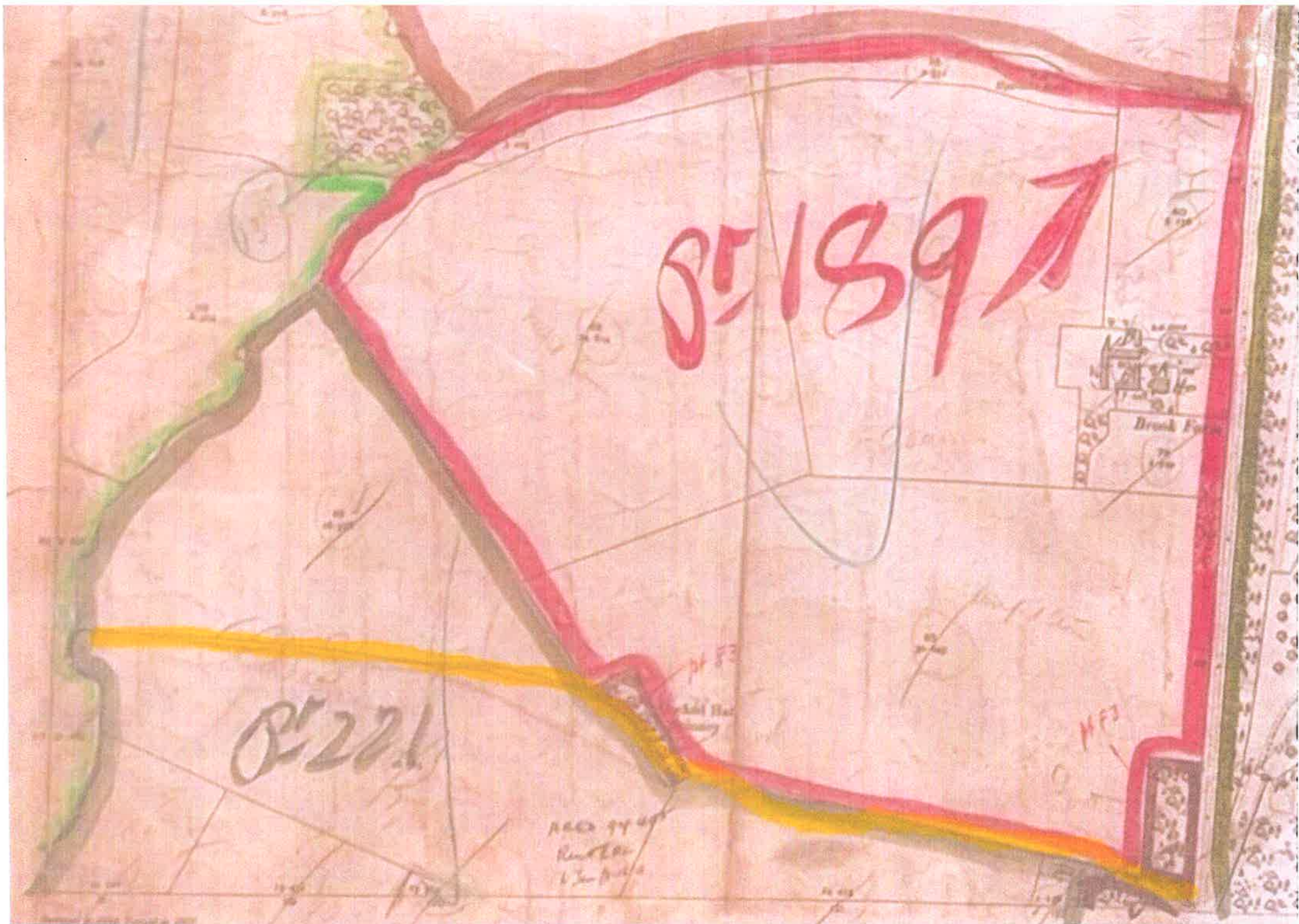



early OS?

can double check

'enclosure map for the area' Kew Archives.

32048398

32086868

32137362

32048464

32080841

54482528

Exton Lane

32059252

32085743

32121458

32123776

32128098

213002
32130518

Boonsdale Avenue

32122050

3217318

54482562

1946

Land Registry.

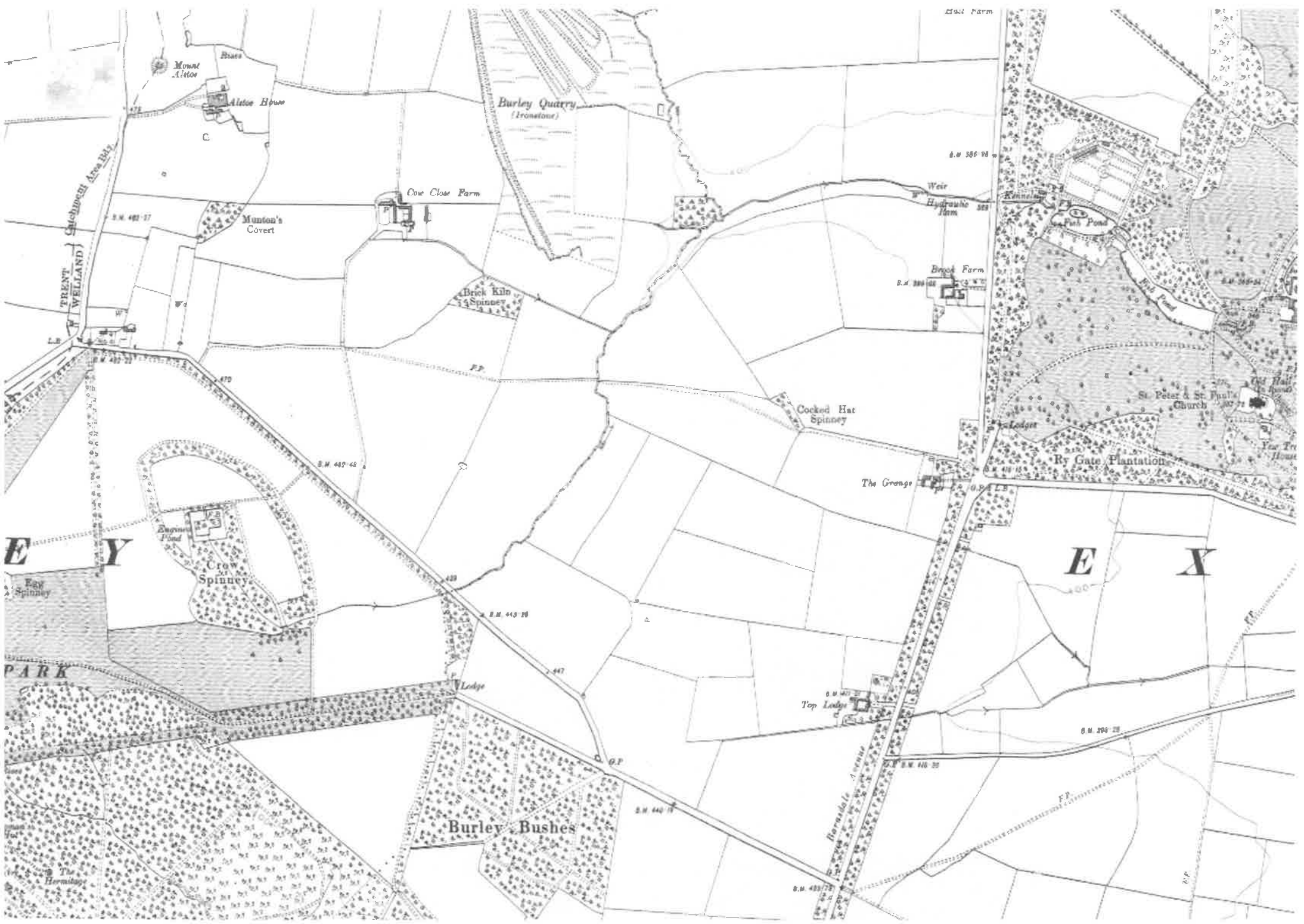

Mount Alton
Alton House

Burley Quarry
(Ironstone)

Cow Close Farm

Munton's
Covert

Brick Kiln
Spinney

Breed Farm

Cocked Hat
Spinney

St. Peter & St. Paul
Church

Ry Gate Plantations

E Y
Eay Spinney
PARK

Crow
Spinney

The Grange

E X

Burley Bushes

Top Lodge

S.M. 206 28

Barnstable Avenue

S.M. 440 18

S.M. 433 18

S.M. 505 98

S.M. 300 48

S.M. 402 27

S.M. 407 45

S.M. 443 20

S.M. 440 30

TRENT
WELLS
CATCHMENT AREA

Coal Farm

Hermitage

Old Hall
House

Year Tree
House

F.P.

F.P.

F.P.

F.P.

G.P.

Lodge

Weir

Hydraulic
Farm

Kenning

Full Pond

Full Pond

Full Pond

Full Pond

Full Pond

Full Pond

Full Pond

Full Pond

Full Pond

Full Pond

Full Pond

Full Pond

Full Pond

Full Pond

Full Pond

Full Pond

Full Pond

Full Pond

Full Pond

Full Pond

Full Pond

Full Pond

Full Pond

Full Pond

S.M. 201 28

S.M. 202 28

S.M. 203 28

S.M. 204 28

S.M. 205 28

S.M. 206 28

S.M. 207 28

S.M. 208 28

S.M. 209 28

S.M. 210 28

S.M. 211 28

S.M. 212 28

S.M. 213 28

S.M. 214 28

S.M. 215 28

S.M. 216 28

S.M. 217 28

S.M. 218 28

S.M. 219 28

S.M. 220 28

S.M. 221 28

S.M. 222 28

S.M. 223 28

S.M. 224 28

S.M. 225 28

Scottish 22

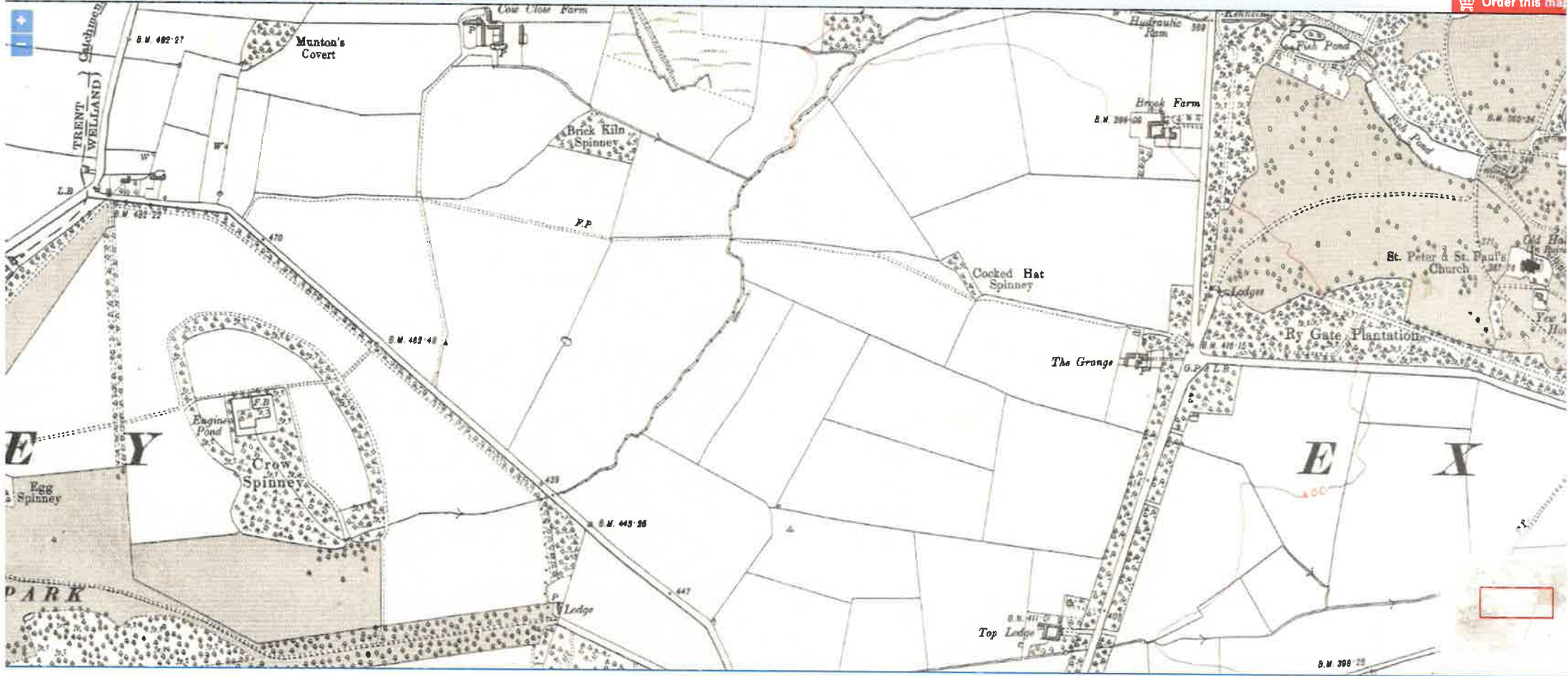

Scattered os

From: McNally mcnallyuk@aol.com
Subject: Definitive map
Date: 24 Aug 2022 at 18:40:56
To: Peter McNally mcnallyuk@aol.com

RCC

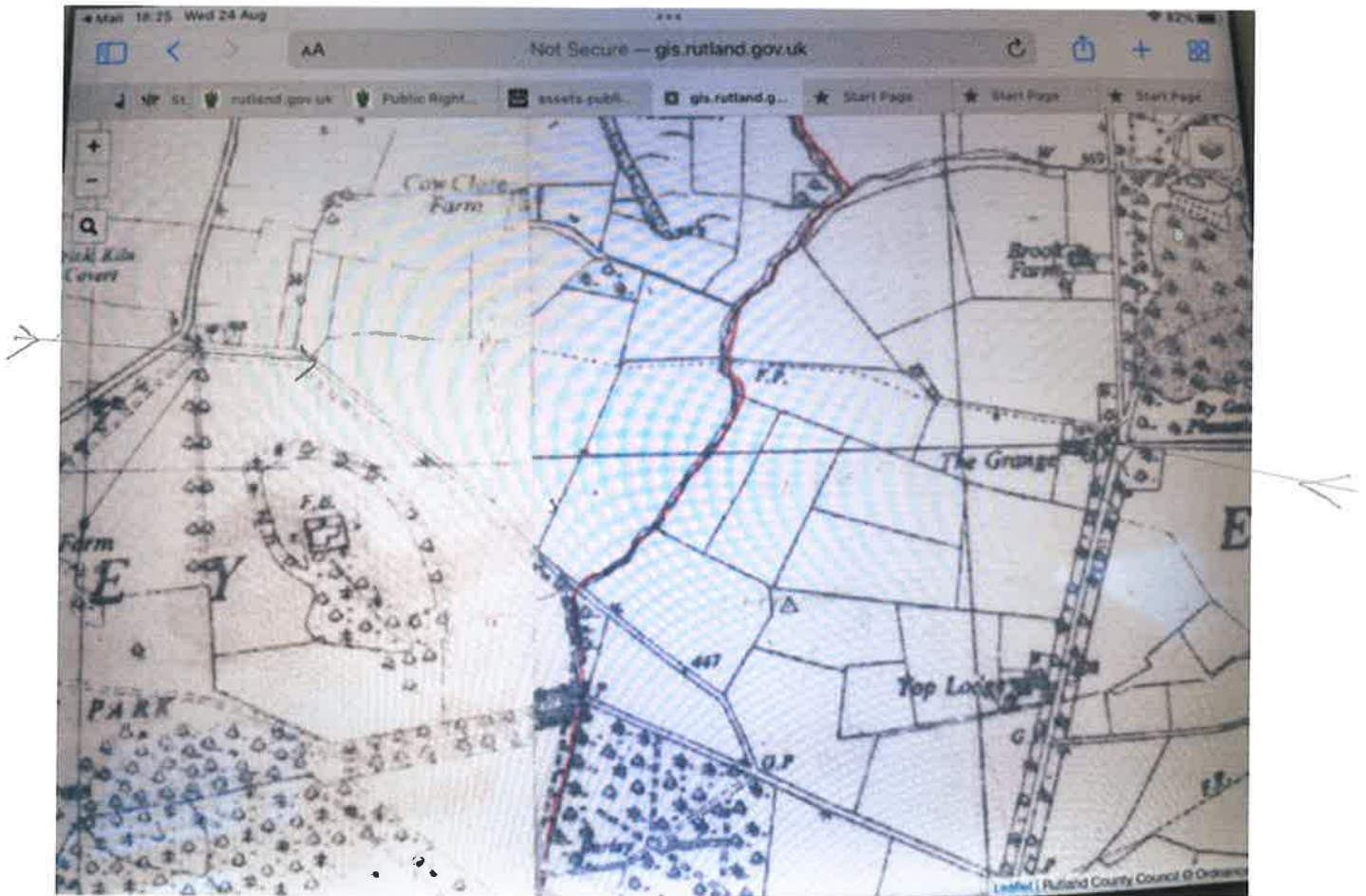

Sent from my iPhone

*Taken from "old definitive maps for the county"
filed at Rutland C.C.*

GRANGE FARM END OF
HISTORIC FOOTPATH TO BURLEY
(NOTE P.O., LETTER BOX)





LOOKING FROM GRAYCE FARM,
THE AVENUE TO THE EXTON ESTATE



EARLY PART OF FOOTPATH THROUGH
WOODLAND



CONTINUATION FROM WOODLAND
INTO FOOTPATH (NOW A TRACTOR DRIVE
LEADING ALONG WHEAT FIELD)



THE ENTRANCE/EXIT TO EXTON LANE
OF THE FOOTPATH.



"TOLL BAR HOUSE", EXTON LANE
AT THE END OF THE PATH



EXTON LANE JUNCTION
WITH BURLEY ROAD
(RED PILLAR BOX ON LEFT.)